

Case Study – Inverted Trench

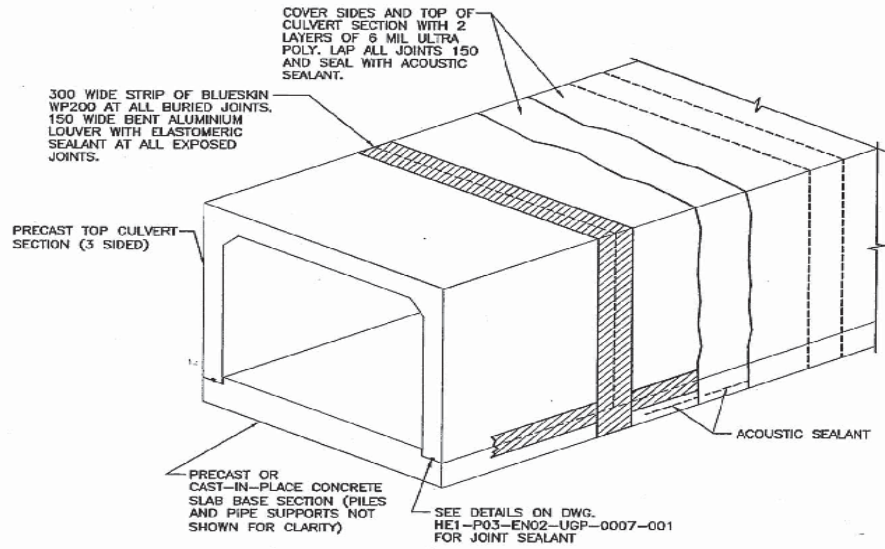

PARTIAL ISOMETRIC OF CULVERTS
SCALE N.T.S.

■ Case Study – Inverted Trench

Project Overview: The customer required a solution to install a new pipeline across a main access road at an Oil Sands project, with minimal disruption to local traffic.

Solution: Lafarge Precast proposed using **custom-sized inverted precast trench units** to provide cover and protection for the new pipeline. These trench units were specifically designed to meet **CL800 load requirements**.

Execution & Benefits:

The design allowed for half of the access road to be excavated at a time, maintaining traffic flow to the site.

The delivery and installation of the inverted precast trench units were completed in just **one week**, despite cold November weather conditions.

Unlike alternative systems, Lafarge's solution avoided **schedule delays** and the additional costs of **winter heating and hoarding**.

**Contact your Lafarge representative,
Call 780-485-4500 or visit
www.lafargeprecastedmonton.com**